

LOWBATT

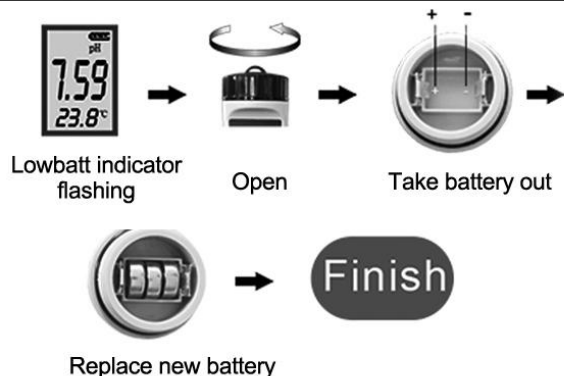

ELECTRODE

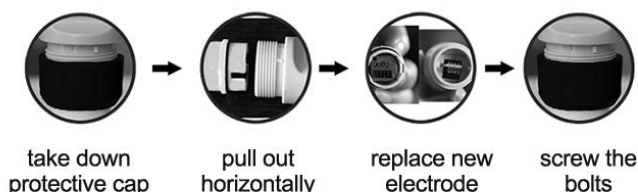

TROUBLESHOOTING

In the power on state, first press and hold the hold / temp key and mode / CAL key at the same time, and do not release them in the middle. After the screen displays "del", release all keys to restore the factory setting.

Attention

1. It has been calibrated by factory, use it directly.
2. After finished, clean the electrode with pure water and keep it dry.
3. Stir gently several times to ensure no air bubble around the electrode.
4. Don't disassemble the meter without permission to avoid damage.
5. Keep it dry.
6. If pH calibration is wrong, please reset.
7. It is a normal phenomenon for H₂ rich hydrogen, PH acid-base, ORP negative potential, etc. to display disorderly values in the air.

Warranty

The meter is warranted to be free from defects in material and workmanship for a period of three years from the date of purchase. The warranty covers normal operation but doesn't cover Man-made damage. Proof of purchase is required for warranty repairs. Warranty is void if the meter used to be taken apart.

Return Authorization

Authorization must be obtained from the supplier before returning items for any reason. When requiring a return authorization, please include data regarding the defective reason, the meter is to be returned along with good packing to prevent any damage in shipment and insured against possible damage or loss.

OPERATION MANUAL

PEN TYPE WATER QUALITY METER

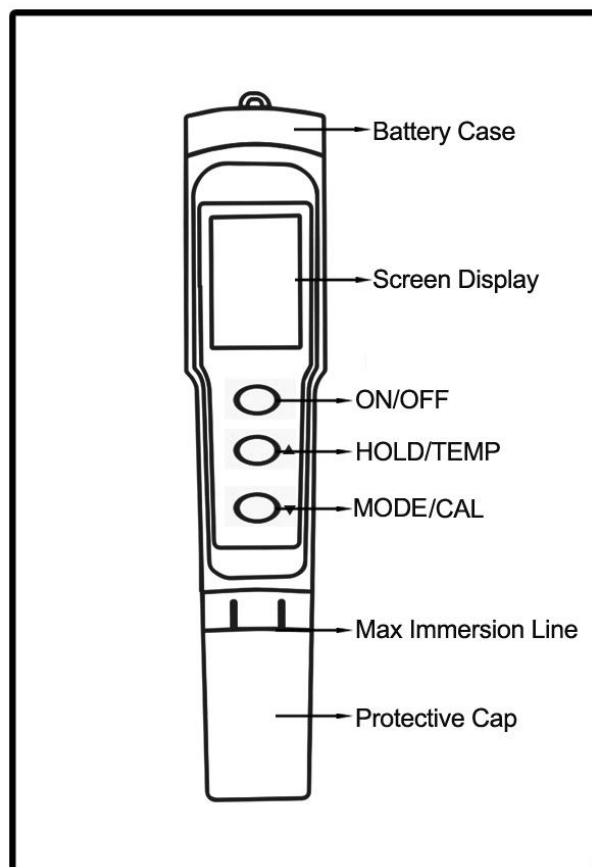

■	pH-03/618/K13	pH/TEMP
■	S-100	TDS/EC/SALT/TEMP
■	EZ9901/986	TDS/pH/TEMP
■	EZ9902/983	EC/pH/TEMP
■	EZ9908/686	TDS/EC/pH/TEMP
■	EZ9910	TDS/pH/ORP/EC/TEMP
■	EZ9909SP	TDS/EC/pH/SALT/TEMP
■	C-200/YY400	pH/H ₂ /ORP/TEMP
■	YY-400H	H ₂ /TEMP
■	C-600	H ₂ /TDS/EC/pH/SALT/S. G/ORP/TEMP
■	JQ-006	H ₂ /TDS/EC/pH/SALT/S. G/ORP/TEMP
		Ω · m / fertile

SCREEN DISPLAY

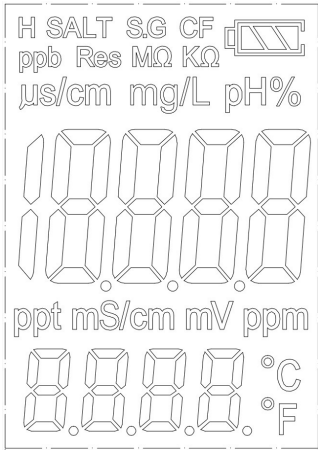

-- Hold and Battery Indicator

-- Testing Values

-- ppm/ppt/ppb

-- μS/cm and mS/cm

-- %

-- pH

-- °C/°F

-- S.G

-- mV

-- Ω · m

BUTTON



Power Button



Hold and Temperature shift button



Mode and Calibration shift button



Adjust values up/down in calibration step

Long press and hold the HOLD/TEMP key for five seconds,

Can convert display of Fahrenheit and Celsius degrees

OPERATION

HOLD/TEMP.SHIFT

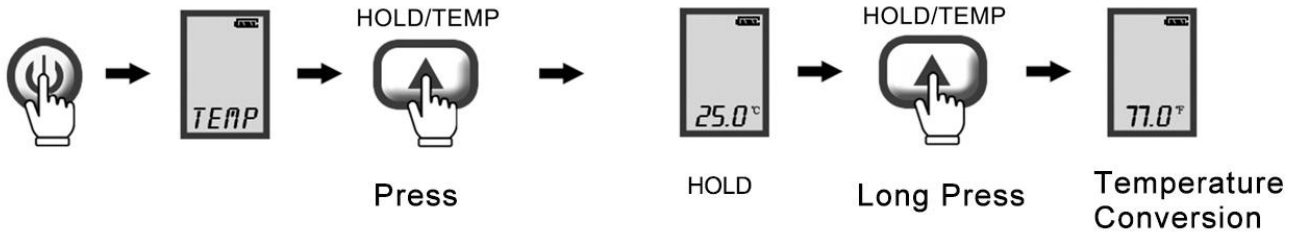

MODE SHIFT

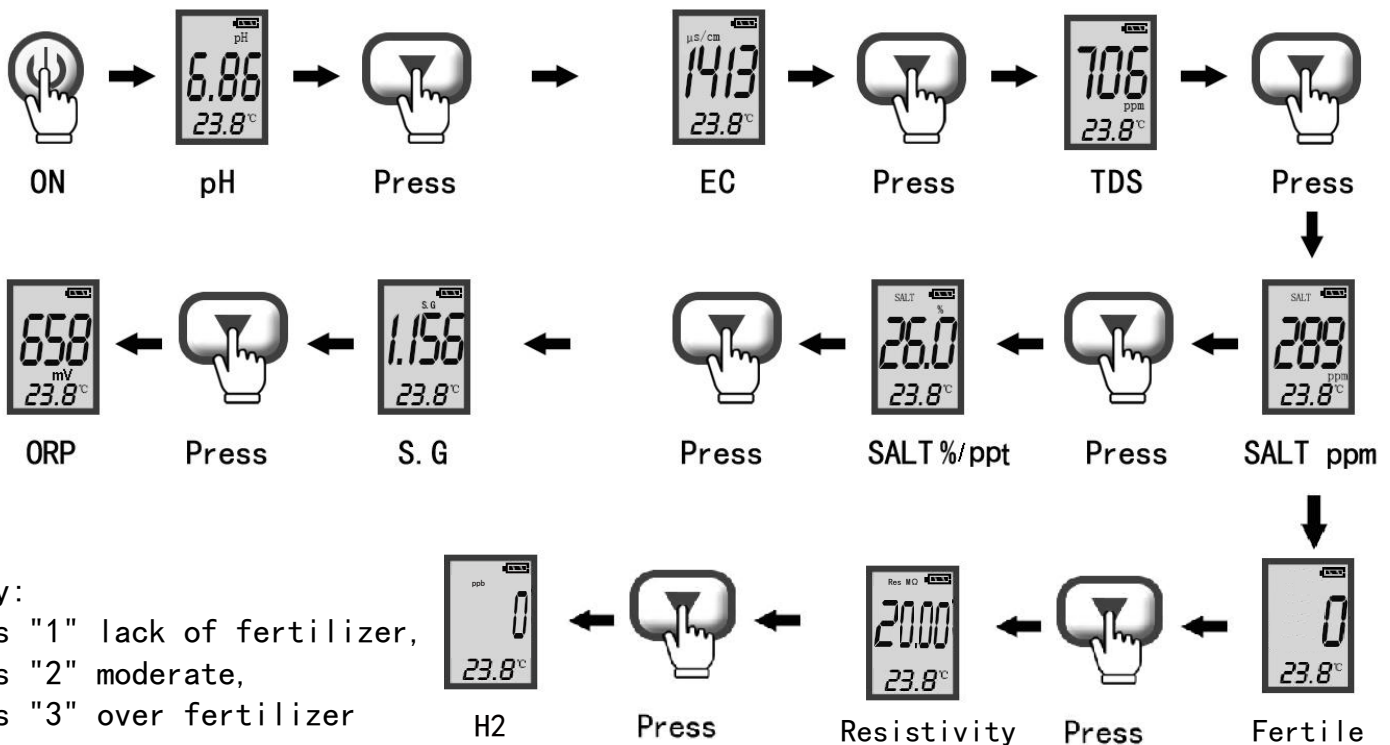

Fertility:
 indicates "1" lack of fertilizer,
 indicates "2" moderate,
 indicates "3" over fertilizer

PARAMETER

ITEM	pH-03	EZ-9901	EZ-9902	EZ-9908	EZ-9910	EZ-9909SP	YY-400	JQ-006	C-600	S-100	
pH	Range: 0.00-14.00pH									/	
	Resolution: 0.01pH									/	
	Accuracy: ±0.05pH									/	
TDS	/	0-200000ppm	/	Range:0-200000ppm,10.1-200.0ppt(10.1-100.0ppt is effective range)			/	Range:0-200000ppm,10.1-200.0ppt(10.1-100.0ppt is effective range)			
	/	Resolution:1ppm;0.1ppt					/	0.1ppm;0.1ppt			
	/	Accuracy:±2%F.S					/	±2%F.S			
EC	/	/	Range:1-199990μS/cm			Range: 0-200000μS/cm,10.1-19.99mS.20.1- 400.0 mS/cm (10.1-200.0mS/cm is effective range)	/	Range:0-200000μS/cm,10.1-19.99mS.20.1-400.0mS/cm(10.1-200.0mS/cm is effective range)			
	/	/	Resolution:1μS/cm; 0.1mS/cm					/	Resolution:1μS/cm;0.1mS/cm		
	/	/	Accuracy:±2%F.S					/	Accuracy:±2%F.S		
SALINITY	/	/	/	/	/	Range: 0.01%-25.00% 0-10000 ppm,10.1-200.0ppt	/	Range:0.01%-25.00% 0-10000ppm,10.1-200.0ppt			
	/	/	/	/	/	Resolution:1ppm;0.1ppt;0.01%	/	Resolution:1ppm;0.1ppt;0.01%			
	/	/	/	/	/	Accuracy:0.01%-5.00%(±0.1%) 5.1%-25.00% (±1%) ±2%F.S	/	Accuracy:0.01%-5.00%(±0.1%) 5.1%-25.00% (±1%) ±2%F.S			
ORP	/	/	/	/	Range:±1999mV	/	Range:±1999mV	Range:±1999mV	/		
	/	/	/	/	Resolution:1mV	/	Resolution:1mV	Resolution:1mV	/		
	/	/	/	/	Accuracy:±2mV		Accuracy:±2mV	Accuracy:±2mV	/		
H ₂	/	/	/	/	/	/	Range: 0-10000ppb 0-10.000ppm			/	
	/	/	/	/	/	/	Resolution:1ppb 0.001ppm			/	
	/	/	/	/	/	/	Accuracy:±10ppb ±0.01ppm			/	
S.G	/	/	/	/	/	/	/	1.000-1.222		/	
Ω · m	/	/	/	/	/	/	/	50 Ω-20 Ω · m		/	
Fertile	/	/	/	/	/	/	/	0-3		/	
Temperature	ATC:0-60℃										
Calibration	/	EC:(1413μS/cm,12.88mS/cm,111.8mS/cm) ---- Press the hold / temp key to increase the value and the mode / CAL key to decrease the value					/	EC: (1413μS/cm,12.88mS/cm,111.8mS/cm) ----Press the hold / temp key to increase the value and the mode / CAL key to decrease the value			
	pH:One point or two points or three points automatically ----If the meter can't identify the solution, change the electrode or contact supplier										/
Waterproof Level	IP65	IP65	IP65	IP65	IP67	IP67	IP67	IP67	IP67	IP67	
Operation Environment	0-60℃ (32-140℉) ; RH100%					Battery	3*1.5V(LR44)				
TDS Factor	0.5					Screen Size	33*24mm				
Temperature Range	0-60℃/32-140℉					Dimension Weight	183*37*37mm(7.2*1.5*1.5in)/90g(3.2oz)				
Temperature Accuracy	±0.5℃					Display	LCD Digital Display				
Temperature Resolution	1℃/℉					Backlight	Backlight is optional				
Automatic Shut-off	5 minutes					Attention	Clean the electrode after using				

pH CALIBRATION

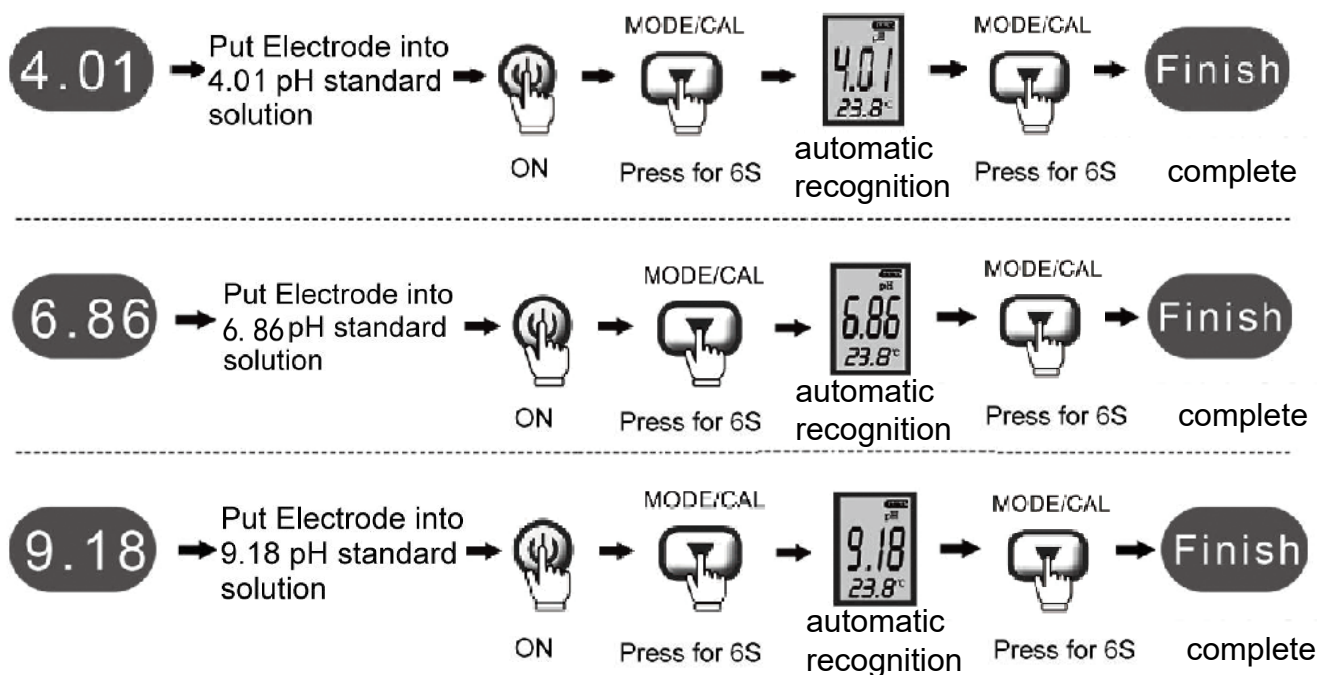

CALIBRATION (EC/TDS/SALT)

